



Symbol	Parameter	Values	Unit
CES	Collector-emitter voltage	650	V
GES	Gate-emitter voltage	± 20	V
C	Continuous collector current ($T_c=25^\circ\text{C}$)	12	A
	Continuous collector current ($T_c=100^\circ\text{C}$)	6	A
CM	Pulsed collector current, I_p limited by v_{jmax}	24	A
F	Diode continuous forward current ($T_c=100^\circ\text{C}$)	6	A
FM	Diode maximum current, I_p limited by v_{jmax}	24	A
sc	Short circuit withstand time	8	μs
tot	Power dissipation ($T_c=25^\circ\text{C}$)	88	W
	Power dissipation ($T_c=100^\circ\text{C}$)	44	W
vj	Operating junction temperature range	-40 to +175	
stg	Storage temperature range	-55 to +150	



Symbol	Parameter	Test condition	Values			Unit
			Min.	Typ.	Max.	
V_{CES}	Collector-emitter breakdown voltage	$V_{GE}=0V, I_C=250\mu A$	650	-	-	V
I_{CES}	Collector-emitter leakage current	$V_{CE}=650V, V_{GE}=0V$	-	-	10	μ

COJ

СНИПЧЕ 6

Ø 2

-

0



Symbol	Parameter	Test condition	Values			Unit
			Min.	Typ.	Max.	
d(on)	Turn-on delay time		-	9	-	ns
r	Rise time		-	18	-	ns
d(off)	Turn-off delay time	CC=400V GE=0/15V	-	24	-	ns
f	Fall time	c=6A G=10	-	91	-	ns
on	Turn-on energy	Inductive load	-	0.18	-	mJ
off	Turn-off energy		-	0.09	-	mJ
ts	Total switching energy		-	0.27		

Turn-on

delay

d(on)

turn

**Electrical characteristics of Diode** ($v_j=25$ unless otherwise specified)

Symbol	Parameter	Test condition	Values			Unit
			Min.	Typ.	Max.	
F	Diode forward voltage	$F=6A$	-	1.4	-	V
		$F=6A, v_j=175$	-	1.2	-	V
t_r	Diode reverse recovery time	$R=400V$ $F=6A$ $d F/d = -500A/\mu s$	-	55	-	ns
I_{rrm}	Diode peak reverse recovery current		-	10	-	A
Q_{rr}	Diode reverse recovery charge		-	306	-	nC
t_r	Diode reverse recovery time	$R=400V$ $F=6A$ $d F/d = -500A/\mu s$ $v_j=175$	-	98	-	ns
I_{rrm}	Diode peak reverse recovery current		-	12	-	A
Q_{rr}	Diode reverse recovery charge		-	529	-	nC

Typical performance characteristics

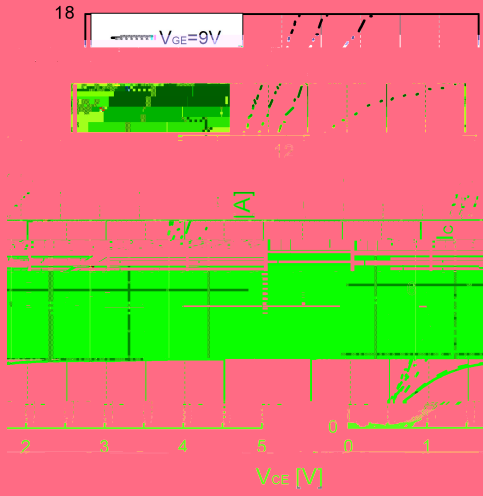

Fig 1. Typical output characteristic ($v_j=25$)

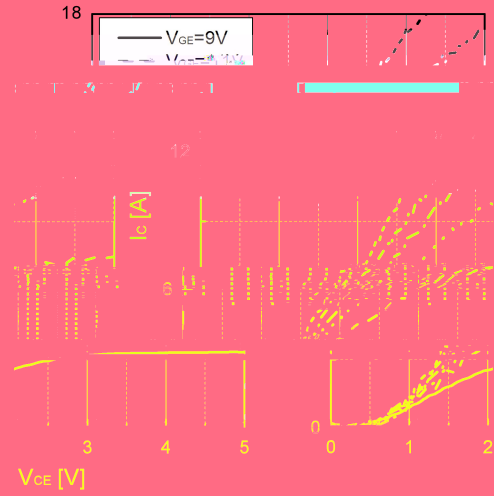

Fig 2. Typical output characteristic($v_j=175$)

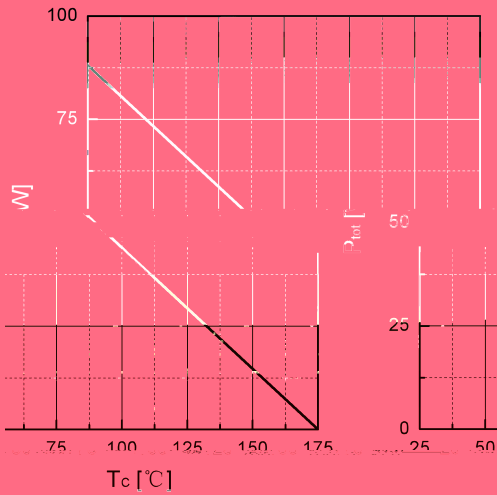

Fig 3. Power dissipation as a function of

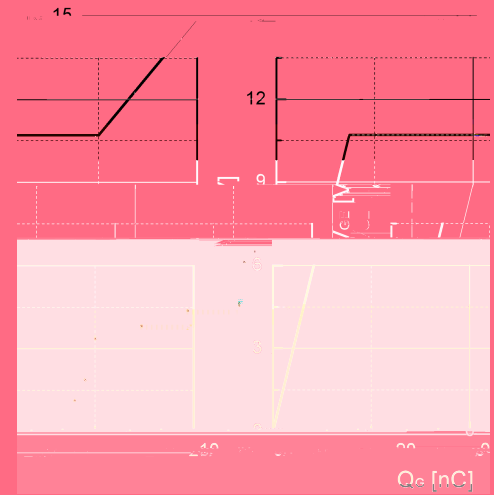

Fig 4. Typical Gate charge

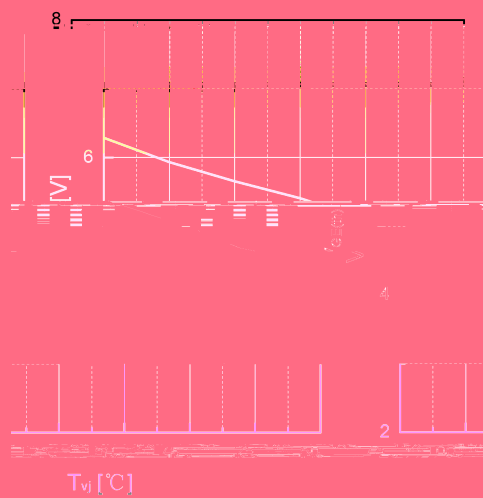

Fig 5. Typical $V_{GE(th)}$ as a function of v_j
($I_C=1mA$)

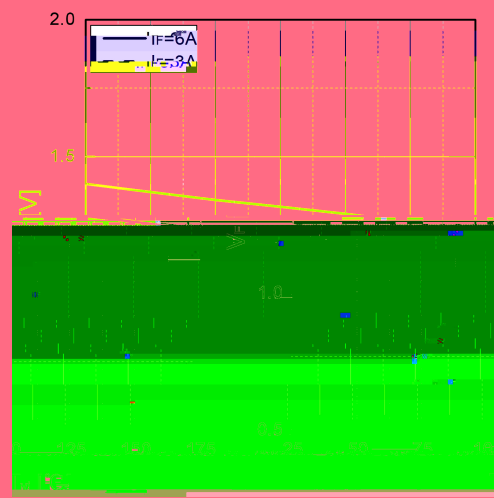

Fig 6. Typical F as a function of v_j



Typical performance characteristics

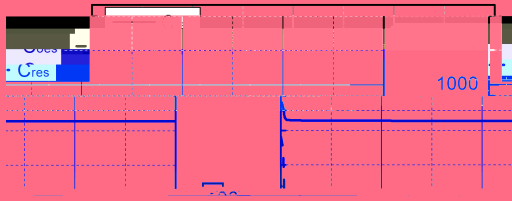
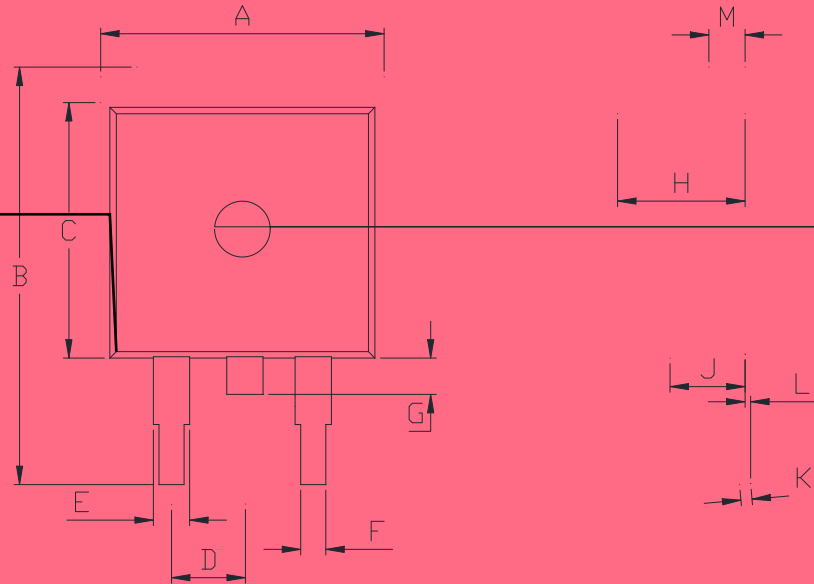

Fig 13. Typical capacitance as a function of C_E
($f=1\text{Mhz}$,

Package dimension

TO-263



Ref.	Dimensions					
	Millimeters			Inches		
	Min.	Typ.	Max.	Min.	Typ.	Max.
A	9.90	-	10.20	0. 0	-	0.402
B	14.70	-	15.80	0.5	-	0. 2
C	9.4	-	9.6	0.	-	0. 8
D	-	2.54	-	-	0.100	-
E	1.20	-	1.40	0.047	-	0.055
F	0.75	-	0.85	0.029	-	0.033
G	-	-	1.75	-	-	0.069
H	4.40	-	4.70	0.1	-	0.185
J	2.	-	2.70	0.091	-	0.106
K	0.	-	0.55	0.015	-	0.022
L	M	M10	M25	M	M004	M010
M	1.25	-	1.	0.049	-	0.053



Date	Revision	Changes
2025-03-19	1.0	Release of the datasheet

Disclaimer

PLEASE NOTE - Jiangsu JieJie Microelectronics Co., Ltd ("JJM") reserves the right to amend, correct, modify and enhance the product and/or this document at any time without prior notice. If you intend to purchase this product, please obtain the latest information available before placing your order. The sale of JJM products is governed by JJM's prevailing terms and conditions at the time of purchase and purchasers are sole buyers.